

THOT Stem Heater

◆ **Type:** THOT-1

THOT-2



◆ **Parameter:**

Type	Stroke	Voltage	Power	Temperature Range
THOT-1	20mm	24VAC/DC	15W	80~120℃
THOT-2	40mm	24VAC/DC	15W	80~120℃

◆ **Wiring instructions for joints:**

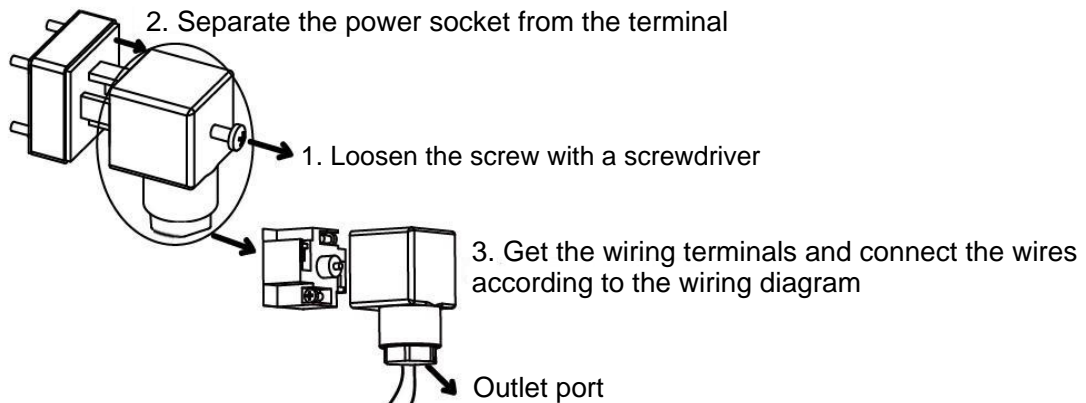

◆ **Installation Instruction:**

1.

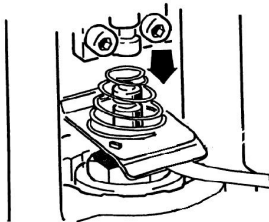

2.

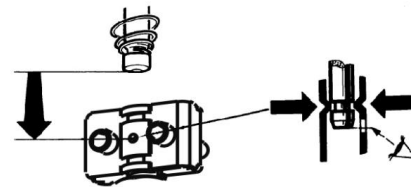

Note: put the side with "24V, 15W" silk print down.

3.

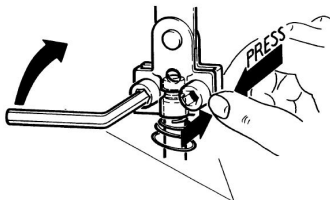

4. Tie the joint to the bracket

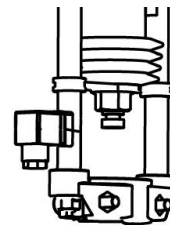

◆ **Wiring Diagram:**

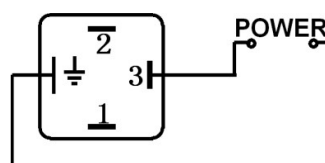

◆ **Accessories:** turriiform spring*1